

Soils Map

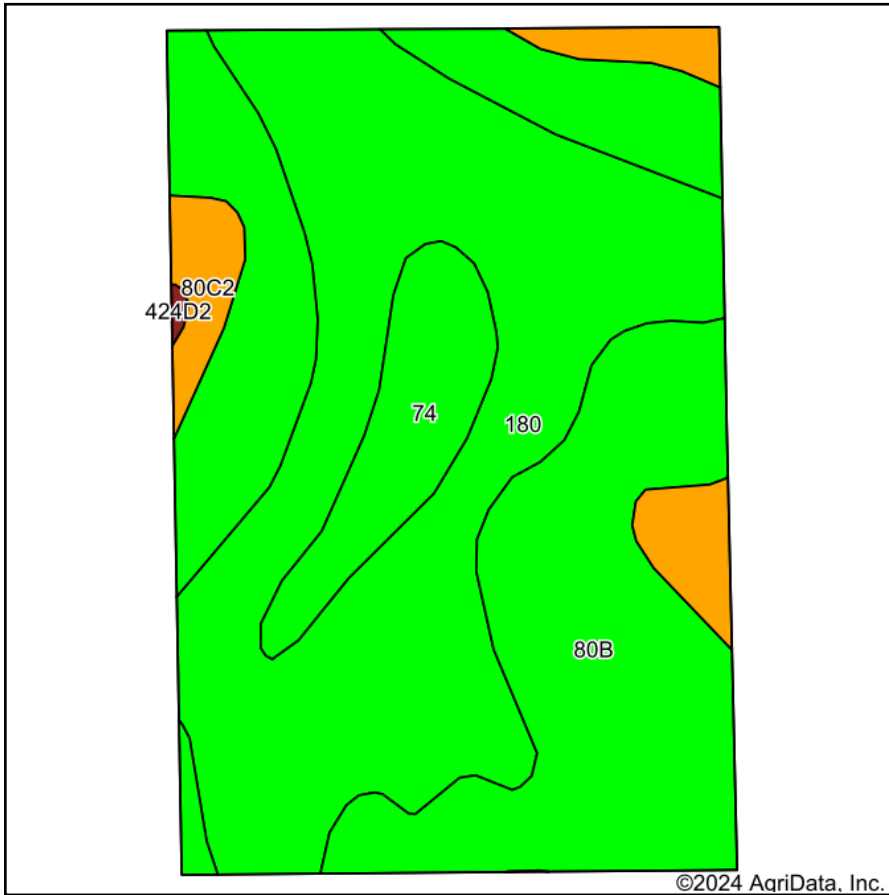

Soils data provided by USDA and NRCS.

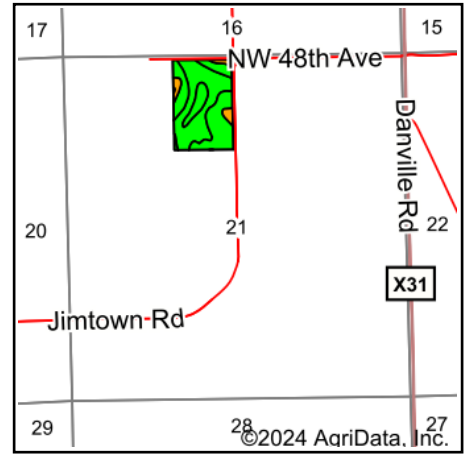

State: **Iowa**
 County: **Des Moines**
 Location: **21-71N-4W**
 Township: **Pleasant Grove**
 Acres: **28.74**
 Date: **4/4/2024**



Maps Provided By:



© AgriData, Inc. 2023

www.AgriDataInc.com



Area Symbol: IA057, Soil Area Version: 28

Code	Soil Description	Acres	Percent of field	CSR2 Legend	Non-Irr Class *c	CSR2**	CSR	
180	Keomah silt loam, 1 to 3 percent slopes	13.05	45.4%		Iw	76	76	
80B	Clinton silt loam, 2 to 5 percent slopes	11.81	41.1%		Ile	80	80	
74	Rubio silt loam, 0 to 2 percent slopes	2.13	7.4%		IIIw	76	78	
80C2	Clinton silt loam, 5 to 9 percent slopes, eroded	1.75	6.1%		IIle	69	60	
Weighted Average						1.68	77.2	76.8

**IA has updated the CSR values for each county to CSR2.

*c: Using Capabilities Class Dominant Condition Aggregation Method